

Osaka YMCA Gakuin Japanese Language School & International College

Student Dormitory Information

Osaka YMCA Gakuin Japanese Language School (P.2~P.5)

- ① Chateau Imazato 1 / ② Chateau Imazato 2 / ③ Chateau Bisyoen
④ TSURUMIBASHI NOIE / ⑤ Chateau Daikoku 2 /
⑥ Cycle yard Osaka / ⑦ Chateau Astina Koraibashi /
⑧ La Parte / ⑨ Estemar Tsuruhashi 2 /
⑩ R-Momodani / ⑪ R-NAMBA SOUTH / ⑫ FC-Tezukayama /
⑬ M-Yamasaka / ⑭ Teradacho Heights / ⑮ R-Nishitanabe /



Osaka YMCA International College (P.6~P.10) Japanese Language School

- ⑯ Chateau Daikoku / ⑰ Chateau Daikoku 2
⑱ Chateau Kujo / ⑲ Chateau Kujo 2
⑳ ~ ㉔ LeaLea Kujo (51, 52, 53, 55, 56)
㉕ ~ ㉘ Lea Lea Midoribashi (23, 25, 26, 30)
㉙ ORI Daikokucho / ㉚ NA Kujo
㉛ V Shinosaka / ㉜ R-SEKIME

Common dormitory in both schools (P.10)

- ㉝ ~ ㉞ Chateau Hanazono (3, 4, 7)



- * The nearest station, commuting hours, transportation fee in this booklet are calculated from each school.
- * Information can be changed depending on the situation.

*The nearest station, commuting hours, transportation fee in this brochure is calculated from each school.
 *Information can be changed depending on the situation.
 *According to the local ordinance of Osaka City, oversized garbage disposal fee is required when disposing of Futons (Futon / blanket (up to 4 sheets) 200 yen). Please be careful when moving out.

Osaka YMCA Gakuin			
	①Chateau Imazato1	②Chateau Imazato2	③Chateau Bishoen
	Male・Female		Male・Female
Location			
Address	3-2-16, Shin Imazato, Ikuno-ku, Osaka-city	3-2-7, Shin Imazato, Ikuno-ku, Osaka-city	1-8-20, Kitatanabe, Higashisumiyoshi-ku, Osaka-city
Nearest station	Kintetsu Nara line /Osaka line [Imazato]		JR Hanwa line [Bishoen]
Commuting time	About 25minutes Walk→ Kintetsu (train)→ JR loop line →Walk		About 13minutes Walk →JR Hanwa line→Walk
Transportation fee	commuting ticket (3months) :26,240 yen commuting ticket for students(3months) :12,670 yen		commuting ticket (3months) :11,300yen commuting ticket for students (3months) : 6,590yen
(Bicycle)	About 25minutes		About 11minutes
Fee			
Deposit etc	Deposit ¥0 At the time of moving in :house cleaning fee ¥25,000		Deposit ¥0 At the time of moving in :house cleaning fee ¥25,000
Rent	¥29,000~39,000/month (Included :maintenance fee and water fee)		¥46,000/month (Included:maintenance and water fee)
Others	Electricity fee : Actual expenses Gas fee : Actual expenses Fire insurance ¥500/month		Electricity fee: Actual expenses Gas fee:Actual expenses Fire insurance fee ¥500/month
Initial cost on move in date	Deposit ¥0 Rent at the current month(daily payment) + rent for next month Fire insurance ¥500(not daily) House cleaning fee ¥25,000		Deposit ¥0 Rent at the current month(daily payment) + rent for next month Fire insurance ¥500(not daily) House cleaning fee ¥25,000
Room, facility			
Room	12.15~13.74㎡		22.91~23.36㎡
Bath room	Unit bath		Unit bath
Mini kitchen	○		○
Internet	Free Wi-Fi is available at all rooms. (Available from the day of move in, Separate charge / penalty is not needed) ※Cable is available.		Free Wi-Fi is available at all rooms. (Available from the day of move in, Separate charge / penalty is not needed) ※Cable is available.
Others	Air conditioner, refrigerator, washing machine, lighting, IH cooking heater, desk, chair, folding bed, sectional closet (Futon: proxy purchase before moving in is possible for those who need...¥8,000/rental fee... ¥6,000/3months) (Additional option of furniture- microwave, rice cooker ...¥10,000) Registration fee for bicycle parking area: ¥1,000 (first time only)		Air conditioner, refrigerator, washing machine, lightening, IH cookingheater, desk, chair, bed, sectional closet ((Futon: proxy purchase before moving in is possible for those who need...¥8,000) (Additional option of furniture- microwave, rice cooker ...¥10,000) Registration fee for bicycle parking area:¥1000 (only the first time)
Shared facilities			
	Registration fee for bicycle parking area: ¥1,000 (first time only)/ Janitor assigned	Elevator/ Bicycle parking area/ Janitor assigned	Elevator/ Entrance :self lock/ Bicycle parking area/ Janitor assigned

Terms of contract with temporary visitor visa

Chateau Imazato1	Chateau Imazato2	Chateau Bishoen
¥158,000/ 3months Electricity fee, Gas fee, Water fee, Internet fee are included.(only darker rooms)		No

Chateau Imazato 1

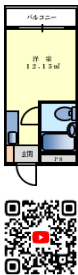

Chateau Imazato 2

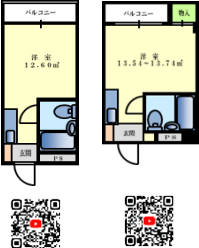

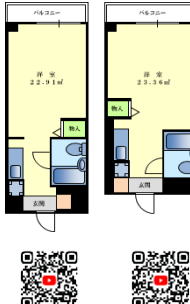

 Rental furniture
 (Long term contract 2sets \10,000)

*The nearest station, commuting hours, transportation fee in this brochure is calculated from each school.
 *Information can be changed depending on the situation.
 *According to the local ordinance of Osaka City, oversized garbage disposal fee is required when disposing of Futons (Futon / blanket (up to 4 sheets) 200 yen). Please be careful when moving out.

Osaka YMCA Gakuin			
	④TSURUMIBASHI noie (Share House)	⑤Chateau Daikoku 2(short term)	⑥Cycle Yard Osaka(a shared house)
	Male・Female	Male・Female	Male・Female
Location			
Address	3-8-16, Tsurumibashi, Nishinari-ku, Osaka-city	3-7-9, Daikoku, Naniwa-ku, Osaka-city	1-19-20 sunjiyata Higashisumiyoshi-ku Osaka
Nearest station	Subway Yotsubashi line [Hanazonocho]	JR Yamatoji/loop line [Imamiya]	Kintetsu Minami Osaka line [Yata]
Commuting time	About 29minutes Walk→ Subway Yotsubashi line→ Midosuji line→Walk	About 10minutes Walk→JR loop line→ Walk	About 20 minutes walk → Kintetsu →walk
Transportation fee	commuting ticket (3months) :25,940 yen commuting ticket for students (3months) :11,970 yen	commuting ticket (3months) :11,300 yen commuting ticket for students(3months) :6,590 yen	commuting ticket (3months) : 21,920yen commuting ticket for students (3months) : 10,350 yen
(Bicycle)	About 20minutes	About 15minutes	About 30 minutes
Fee			
Deposit etc	Move in fee ¥20,000 (Non refundable)		Deposit ¥20,000 (Refundable at the time of moving out)
Rent	¥29,000～32,000／month	Only short-term contracts are accepted. See below for details of the contract.	¥38,000/month (Exclusive discount for YMCA students) (Included:maintenance, electricity, gas, water fee)
Others	Management fee: ¥13,200/month (Included: Water fee, Gas fee, Electricity fee, Internet fee) Fire insurance ¥500/month		Rent is paid monthly from the contract start date, calculated on a daily basis when you move out. Electricity fee : Actual expenses
Initial cost on move in date	Move in fee ¥20,000 Rent at the current month (daily payment) + rent for next month Management fee at the current month (daily payment) + Management fee for next month Fire insurance ¥500(not daily)	182,000 yen for 3 months * Includes electricity, gas, water, internet, fire insurance, and cleaning fees	Deposit 20,000 yen + Monthly rent + bicycle parking fee 1,000 yen Minimum contract period is 1 month
Room, facility			
Room	7.17～9.63㎡	12.44～12.61㎡	10㎡ (6mat)
Bath room	Share	Unit bath	Bath room only
Mini kitchen	Share	○	○
	Free Wi-Fi is available at all rooms. (Available from the day of move in, Separate charge / penalty is not needed) *Cable is available.	Free Pocket Wi-Fi is available at all rooms. (Available from the day of move in, Separate charge / penalty is not needed) *Cable LAN is also available.	Free Wifi available (Available from the day you move in)
Others	Air Conditioner, Refrigerator, Desk, Chair, Bed, Sectional Closet, Curtain (Futon: proxy purchase before moving in is possible for those who need...¥8,000)	Air conditioner, refrigerator, washing, lighting, IH cooking heater, desk, folding bed (Futon: proxy purchase before moving in is possible for those who need ...¥8,000) Registration fee for bicycle parking area: ¥1,000 (first time only)	air conditioner, refrigerator, desk, chair, bed, clothes case
Shared facilities			
	CCTV, Shoebox, Washing Machine, Clothes Dryer Machine, Sink, Shower Room, Toilet, Microwave, Rice Cooker, IH Heater, TV, Dining Table	Elevator Janitor assigned	kitchen (IH 6pcs) ,microwave, toaster

Terms of contract with temporary visitor visa

TSURUMIBASHI noie (Share House)	Chateau Daikoku 2	Cycle Yard Osaka
¥155,880～164,880/ 3months (Futon rental fee ¥6,000/3months) Electricity fee, Gas fee, Water fee, Internet fee & House Cleaning Fee are included.	¥182,000/ 3months Electricity fee, Gas fee, Water fee, Internet fee & House Cleaning Fee are included.	Deposit ¥20,000 (Rent at the current month (daily basis) + Bicycle parking fee¥1000 Shortest contract period 1month

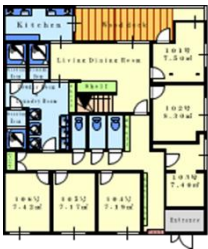

1F

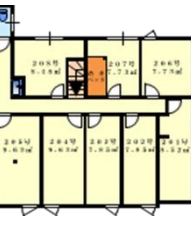

2F





Rental furniture



(Short term contract: equipped with for free)

*The nearest station, commuting hours, transportation fee in this brochure is calculated from each school.
 *Information can be changed depending on the situation.
 *According to the local ordinance of Osaka City, oversized garbage disposal fee is required when disposing of Futons (Futon / blanket (up to 4 sheets) 200 yen). Please be careful when moving out.

Osaka YMCA Gakuin			
	⑦Chateau Astina Koraibashi	⑧La Parte	⑨Estemar Tsuruhashi2
	Male・Female／(1person)	Male・Female	Male・Female
Location			
Address	1-7 Higashi Koraibashi, Chuo Ward, Osaka City	1-9-21, Minamisenba, Chuo-ku, Osaka-city	1-3-18, Tsuruhashi, Ikuno-ku, Osaka-city
Nearest station	Subway "Temmabashi"	Osaka Metro Midousuji line [Shinsaibashi]	Subway Sennichimae line, JR loop line Kintetsu line (Tsuruhashi)
Commuting time	About 24 minutes Walk→Subway Tanimachi Line →Walk	About 28minutes Walk→ Osaka Metro Midousuji line→ Walk	About 14minutes Walk → JR loop line → Walk
Transportation fee	commuting ticket (3months) : 25,940yen commuting ticket for students(3months) : 11,970yen	commuting ticket (3months) : 25,940 yen commuting ticket for students (3months) : 11,970 yen	commuting ticket (3months) : 11,300yen commuting ticket (3months) : 6,590yen
(Bicycle)	About 26 minutes	About 19minutes	About 11minutes
Fee			
Deposit etc	Deposit 67,500 to 97,500 yen (no refund) When moving in: House cleaning 25,000 yen	Deposit ¥65,500～70,500 (Non refundable) At the time of moving in :house cleaning fee ¥20,000	Deposit 1month rent fee (will be refunded at the time of moving out)
Rent	¥67,500～97,500/month (Included:maintenance, water fee)	¥65,500～70,500/month (Included :maintenance and water fee)	¥39,000～45,000/month (Included:maintenance, water and Internet fee)
Others	Electricity fee : Actual expenses Gas fee : Actual expenses Fire insurance ¥500 (1month)	Electricity fee : Actual expenses Gas fee : Actual expenses Fire insurance ¥500 (1month)	Electricity fee : Actual expenses Gas fee : Actual expenses Parking lot : ¥2,000/month (applicants)
Initial cost on move in date	Deposit ¥67,500～¥97,500 Rent at the current month (daily basis) + rent for next month Fire insurance ¥500 (not daily basis) House cleaning fee ¥25,000	Deposit ¥65,500～70,500 Rent at the current month (daily payment) + rent for next month Fire insurance ¥500 (not daily basis) House cleaning fee ¥20,000	Deposit 1month rent fee (will be refunded at the time of moving out) Rent of current month (daily payment) + rent for next month Fire insurance fee ¥13,000 (2 years)
Room, facility			
Room	21.41～33.59㎡	19.32～21.03㎡	14.72㎡～16.56㎡
Bath room	Separate	Separate	Unit bath
Mini kitchen	○	○	○
Internet	*Free Wi-Fi in all rooms (Available from the day you move in, No separate usage fee, penalty, etc.) *Wired can also be used.	Free Wi-Fi is available at all rooms. (Available from the day of move in, Separate charge / penalty is not needed) *Cable is available.	Free Wifi(40mb)
Others	Air conditioner, shoe cupboard, 2-burner IH stove, bathroom dryer, bathroom vanity, bidet toilet seat, lighting, refrigerator, washing machine, bed, desk, chair, curtains (Futon: Can be purchased by proxy before moving in...8,000 yen) *Additional furniture PL A N Rent +1,000 yen Microwave, rice cooker Rent +2,000 yen TV, TV stand Rent + 3,000 yen Microwave, rice cooker, TV, TV stand	Air conditioner, refrigerator, washing machine, lighting, Gas stove(Two burner),bathroom vanity, desk, chair, bed,curtain Futon:It is available to be on behalf of you before moving in. ※Option furniture Rent +¥1000 microwave, rice cooker Rent +¥2000 TV, TV stand Rent +¥3000 microwave, rice cooker, TV, TV stand	Air conditioner, refrigerator, closet, Electric cooking heater, bed, table, shoebox, curtain Optional furnitures: Futon...¥8,000, rice cooker...¥6,000 or microwave+ rice cooker ...¥10,000
Shared facilities			
	Auto lock / security camera Elevator・Delivery box Free bicycle parking	Automatic lock entrance, Security camera, Elevator, Free bicycle parking area	Elevator, Coin laundry (washing machine, drying machine- charged), Automatic lock entrance, Manager is stationed, Delivery box

Terms of contract with temporary visitor visa

	Chateau Astina Koraibashi	La Parte	Estemar Tsuruhashi2
	No	No	No

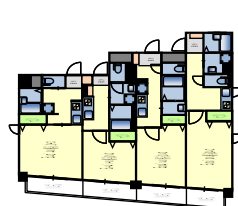

[Twitter account]

@DAITETSU_JUTAKU

*The nearest station, commuting hours, transportation fee in this brochure is calculated from each school.
 *Information can be changed depending on the situation.
 *According to the local ordinance of Osaka City, oversized garbage disposal fee is required when disposing of Futons (Futon / blanket (up to 4 sheets) 200 yen). Please be careful when moving out.

Osaka YMCA Gakuin			
	⑩R-Momodani	⑪R-NANBA SOUTH	⑫FC-Tezukayama
	Male・Female	Male・Female	Male・Female
Location			
Address	3-8-23 Katsuyamakita, Ikuno-ku, Osaka-city	1-7-14 Hanazonokita, Nishinari-ku, Osaka-city	2-8-14 Bandal, Sumiyoshi-ku, Osaka, Osaka
Nearest station	JR Loop Line (Momodani)	JR Loop Line (Shin-Imamiya)	Midousuji Line Nishitanabe Sta.
Commuting time	About 16minutes Walk → JR loop line → Walk	About 15minutes Walk → JR loop line → Walk	About 20mins Walk→Subway→Walk
Transportation fee	General Commuter Pass (3months) : 11,300yen Student Commuter Pass (3months) : 6,590yen	General Commuter Pass (3months) : 11,090yen Student Commuter Pass (3months) : 6,470yen	General Commuter Pass (3months) : 25,940yen Student Commuter Pass (3months) : 11,970yen
(Bicycle)	About 12minutes	About 20minutes	About 22 mins
Fee			
Deposit etc	①Deposit(Refundable): 0.5month rent fee + RLS ②Basic cleaning fee: ¥22,000 (when moving out) *RLS: Refer to the following "Others"		①Deposit(Refundable): 1month rent fee + RLS ②Basic cleaning fee: ¥22,000 (when moving out) *RLS: Refer to the following "Others"
Rent	¥41,000~¥43,000 /month (Including: maintenance, water fee)	¥63,000 /month (Including: maintenance, water fee)	¥37,000~40,000 /month (Including: maintenance, water fee)
Others	RLS: 2,000 yen / month (rent guarantee, fire insurance, 24-hour emergency response, withdrawal fee), electricity fee: actual cost, gas fee: actual cost	RLS: 2,000 yen / month (rent guarantee, fire insurance, 24-hour emergency response, withdrawal fee), electricity fee: actual cost, gas fee: actual cost	RLS: 2,000 yen / month (rent guarantee, fire insurance, 24-hour emergency response), electricity fee: actual cost, gas fee: actual cost
Initial cost on move in date	Deposit: ¥43,000~ Entrance fee: ¥21,500~ Previous rent: ①Daily payment rent of the current month + RLS and ②Rent for next month + RLS	Deposit: ¥65,000~ Entrance fee: ¥32,500~ Previous rent: ①Daily payment rent of the current month + RLS and ②Rent for next month + RLS	Deposit: ¥39,000~ Entrance fee: ¥19,500~ Previous rent: ①Daily payment rent of the current month + RLS and ②Rent for next month + RLS
Room, facility			
Room	16㎡ (1R)	22㎡ (1K)	15㎡ (1R)
Bath room	Unit Bath	Separate	Unit Bath
Mini kitchen	○		○
	Free Wi-Fi is available at all rooms. (available from the day of move in, separate charge/penalty is not needed)		
Others	Home appliances: 2-door refrigerator, microwave oven, vacuum cleaner, washing machine, air conditioner Furniture: Beds, chairs, desks, closets, curtains, lighting Options: Futon 9,000 yen, rice cooker 7000 yen		
Shared facilities			
	Elevator, Auto lock, bicycle parking lot	Elevator, Auto lock, bicycle parking lot	Stairs, Bicycle parking space

Terms of contract with temporary visitor visa

	R-Momodani	R-NAMBA SOUTH	FC-Tezukayama
	3 months usage fee: 225,000 yen Deposit: 20,000 yen (refund when moving out)		

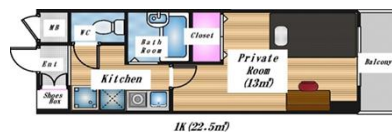
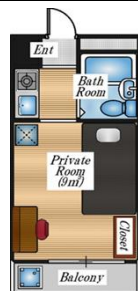

*The nearest station, commuting hours, transportation fee in this brochure is calculated from each school.
 *Information can be changed depending on the situation.
 *According to the local ordinance of Osaka City, oversized garbage disposal fee is required when disposing of Futons (Futon / blanket (up to 4 sheets) 200 yen). Please be careful when moving out.

Osaka YMCA Gakuin			
	⑬M-Yamasaka	⑭Teradacho Heights	⑮R-Nishitanabe
	Male・Female	Male・Female	Male・Female
Location			
Address	2-11-6 Yamasaka, Higashinari-ku, Osaka, Osaka	1-18-21 Ikunonishi, Ikuno-ku, Osaka, Osaka	2-6-21 Nishitanabecho, Abeno-ku, Osaka, Osaka
Nearest station	R Hanwa Line Minami-Tanabe Sta.	JR Osaka Loop Line Teradacho Sta.	JR Hanwa Line Tsurugaoka Sta.
Commuting time	About 20 mins Walk→JR→Walk	About 10 mins Walk 10 mins	About 15 mins Walk→JR→Walk
Transportation fee	General Commuter Pass (3months) : 11,300yen Student Commuter Pass (3months) : 6,590yen	General Commuter Pass (3months) : 11,300yen Student Commuter Pass (3months) : 6,590yen	General Commuter Pass (3months) : 14,110yen Student Commuter Pass (3months) : 7,740yen
(Bicycle)	About 20 mins	About 5mins	About 25 mins
Fee	2 Persons available		
Deposit etc	①Deposit(Refundable): 0.5month rent fee + RLS ②Domitory fee: a rent for half month + RLS *RLS:Refer to the following "Others" ③Basic cleaning fee: ¥22,000 (when moving out)		
Rent	¥40,000～42,000/month	¥76,000～78,000 /month	¥40,000～42,000 /month
	(Including: maintenance, water fee)		(Including: maintenance, water fee, Electricity fee, Gas fee)
Others	RLS: 2,000 yen / month (rent guarantee, fire insurance, 24-hour emergency response) electricity fee: actual cost, gas fee: actual cost		RLS: 2,000 yen/month Electricity fee and Gas fee: included in the rent
Initial cost on move in date	Deposit: ¥42,000～ Domitory fee: 21,000～ Previous rent: ①Daily payment rent of the current month + RLS and ②Rent for next month + RLS	Deposit: ¥78,000～ Domitory fee: 39,000～ Previous rent: ①Daily payment rent of the current month + RLS and ②Rent for next month + RLS	Deposit: ¥39,000～ Domitory fee: 18,500～ Previous rent: ①Daily payment rent of the current month + RLS and ②Rent for next month + RLS
Room, facility			
Room	20㎡ (1K)	28㎡ (2K・1LDK)	13.2～16㎡ (1R)
Bath room	Unit Bath	Separate	Unit Bath
Mini kitchen	○	○	○
Internet	Free Wi-Fi is available at all rooms. (available from the day of move in, separate charge/penalty is not needed)		
Others	*Home appliances: 2-door refrigerator, microwave oven, vacuum cleaner, washing machine(*1), air conditioner(*2) Furniture: Beds, chairs, desks, closets, curtains, lighting Options: Futon 9,000 yen, rice cooker 7000 yen (*1)R-Nishitanabe dose not have a washing machine in each room, so instead of it, has free shared washing machine. (*2) M-Yamasaka and R-Nishitanabe does not have air conditioner heating, so a heater is installed.		
Shared facilities			S
	Stairs, Bicycle parking space	Stairs, Auto lock, Bicycle parking space	Elevator, Auto lock, Bicycle parking space

Terms of contract with temporary visitor visa

	M-Yamasaka	Teradacho Heights	R-Nishitanabe
3 months usage fee: 225,000 yen Deposit: 20,000 yen (refund when moving out)		No	No

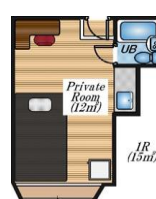
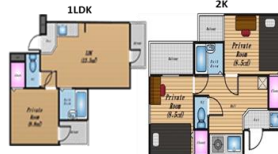

*The nearest station, commuting hours, transportation fee in this brochure is calculated from each school.
 *Information can be changed depending on the situation.
 *According to the local ordinance of Osaka City, oversized garbage disposal fee is required when disposing of Futons (Futon / blanket (up to 4 sheets) 200 yen). Please be careful when moving out.

Osaka YMCA International college				
	⑩Chateau Daikoku	⑪Chateau Daikoku2	⑬Chateau Kujo	⑭Chateau Kujo2
	Male・Female	Male・Female	Male・Female	Male・Female
Location				
Address	3-10-7, Daikoku, Naniwa-ku, Osaka-city	3-7-9, Daikoku, Naniwa-ku, Osaka-city	1-16-9, Kujo, Nishi-ku, Osaka-city	1-12-24, Kujo, Nishi-ku, Osaka-city
Nearest station	Subway Yotsubashi line (Daikoku cho)		Osaka-city bus (Kujo Shinmichi)	
Commuting time	Subway (about 20minutes) walk → subway → walk		Bus (about 15minutes) walk → bus → walk	
Transportation fee	commutation ticket for student (3months) : ¥11,970 commutation ticket for student (6months) : ¥22,680		commutation ticket for student (3months) : ¥14,710 commutation ticket for student (6months) : ¥27,860	
(Bicycle)	Not be able to go to school by bicycle		About 15minutes	
Fee				
Deposit etc	Deposit ¥0 House cleaning fee ¥25,000			
Rent	¥36,000～48,000／month (Included: maintenance and water fee)		¥36,000～43,000／month (Included: maintenance and water fee)	
Others	Electricity fee : Actual expenses Gas fee : Actual expenses Fire insurance : ¥500 (1month)			
Initial cost on move in date	Deposit ¥0 Rent at the current month(daily payment) + rent for next month Fire insurance ¥500 ／month (not daily) Cleaning fee ¥25,000			
Room, facility				
Room	12.15～16.75㎡		12.6～13.43㎡	
Bath room	Unit Bath			
Mini kitchen	○			
Internet	Free Wi-Fi is available at all rooms. (Available from the day of move in, Separate charge / penalty is not needed) ※Cable is available.			
Others	Air conditioner, refrigerator, washing machine, lighting, IH cooking heater, desk, chair, folding bed, closet-hanger (Futon: proxy purchase before moving in is possible for those who need…¥8,000) (Additional option of furniture- microwave, rice cooker …¥10,000) Registration fee for bicycle parking area: ¥1,000 (first time only)			
Shared facilities				
	Elevator/ Janitor assigned/Entrance:self lock	Elevator/ Janitor assigned/Bicycle parking space	Elevator/ Janitor assigned/Bicycle parking space/Entrance:self lock	Elevator/ Janitor assigned/Bicycle parking space/Entrance: self lock

Terms of contract with temporary visitor visa

Chateau Daikoku	Chateau Daikoku2	Chateau Kujo	Chateau Kujo2
No			

Daikoku

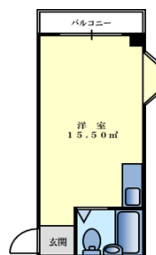

Daikoku 2



Kujo

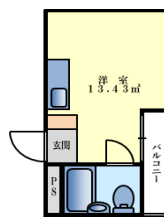

Kujo2

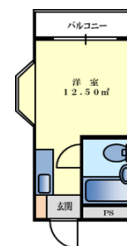

*The nearest station, commuting hours, transportation fee in this brochure is calculated from each school.
 *Information can be changed depending on the situation.
 *According to the local ordinance of Osaka City, oversized garbage disposal fee is required when disposing of Futons (Futon / blanket (up to 4 sheets) 200 yen). Please be careful when moving out.

Osaka YMCA International college					
	②LeaLea Kujo51	②LeaLeaKujo52	②LeaLea Kujo53	②LeaLea Kujo55	②LeaLea Kujo56
	Male · Female				
Location					
Address	3-30-10, Kujo Minami, Nishi-ku, Osaka-city	3-2-16, Honden, Nishi-ku, Osaka-City	2-7-14 Honden, Nishi-ku, Osaka-City	1-2-19, Kujo Minami, Nishi-ku, Osaka-city	1-3-16, Kujo Minami, Nishi-ku, Osaka-city
Nearest station	Osaka-city bus [Sakaigawa]	Osaka-city bus [Honden 1chome]		Osaka-city bus [Hanshin Kujo]	Osaka-city bus [Hanshin Kujo]
Commuting time	About 15minutes walk → bus → walk				
Transportation fee	commutation ticket for student (3months) : ¥14,710 commutation ticket for student (6months) : ¥27,860				
(Bicycle)	About 20minutes				
Fee					
Deposit etc	Deposit ¥50,000 (non refundable) Guarantee fee ¥20,000 (non refundable)				
Rent	¥34,000～36,000				
Others	Maintenance fee :¥7,000 / month Water fee :¥2,500 / month Electricity fee : Actual expenses Gas fee : Actual expenses				
Initial cost on move in date	Deposit ¥50,000 Guarantee Fee ¥20,000 Rent at the current month (daily payment) + rent for next month Fire insurance ¥10,000 (2years) Cleaning fee ¥16,500 Neighborhood association fee ¥3,600				
Room, facility					
Room	About 15㎡				
Bath room	Unit Bath				
Mini kitchen	○				
Internet	¥2,700／month (optical communication), Application needs to be done by oneself and it will take 1-2weeks to get through.				
Others	Air conditoner, refrigerator, bed, closet, lighting (Futon: proxy purchase before moving in is possible for those who need…¥6,200)				
Shared facilities					
	Automatic lock entrance, Elevator Coin laundry	Automatic lock entrance, Elevator Coin laundry	Automatic lock entrance, Elevator	Automatic lock entrance, Elevator Coin laundry	Automatic lock entrance, Elevator Coin laundry

Terms of contact with temporary visitor visa (3month)

LeaLea Kujo51	LeaLea Kujo52	LeaLea Kujo53	LeaLea Kujo55	LeaLea Kujo56
No	No	No	No	No

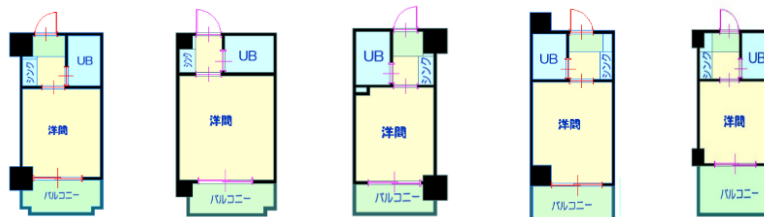

*The nearest station, commuting hours, transportation fee in this brochure is calculated from each school.
 *Information can be changed depending on the situation.
 *According to the local ordinance of Osaka City, oversized garbage disposal fee is required when disposing of Futons (Futon / blanket (up to 4 sheets) 200 yen). Please be careful when moving out.

Osaka YMCA International college				
	LeaLea Midoribashi 23	LeaLea Midoribashi 25	LeaLea Midoribashi 26	LeaLea Midoribashi 30
	Male · Female			
Location				
Address	3-10-2, Higashinakahama, Iyoto-ku, Osaka-City	6-15-10, Higashinakahama, Iyoto-ku, Osaka-City	9-3-32, Higashinakahama, Iyoto-ku, Osaka-City	2-3-18, Nakamoto, Higashinari-ku, Osaka-City
Nearest station	Subway Chuo line [Midoribashi]			
Commuting time	About 40 minutes walk → subway Chuo line → subway Yotsubashi line → walk			
Transportation fee	commutation ticket for student (3months) : 11,970円 commutation ticket for student (6months) : 22,680円			
(Bicycle)	Not be able to go to school by bicycle			
Fee				
Deposit etc	Deposit ¥50,000 (non refundable) Guarantee fee ¥20,000 (non refundable)			
Rent	¥28,000~¥32,000			
Others	Maintenance fee : ¥7,000 / month Water fee : ¥2,500 / month Electricity fee : Actual expenses Gas fee : Actual expenses			
Initial cost on move in date	Deposit ¥50,000 Guarantee Fee ¥20,000 Rent at the current month (daily payment) + rent for next month Fire insurance ¥10,000 (2years) Cleaning fee ¥16,500 Neighborhood association fee ¥3,600			
Room, facility				
Room	約15㎡			
Bath room	Unit Bath			
Mini kitchen	○			
Internet	¥2,700/month (optical communication), Application needs to be done by oneself and it will take 1-2weeks to get through.			
Others	Air conditioner, refrigerator, bed, closet, lighting (Futon: proxy purchase before moving in is possible for those who need...¥6,200)			
Shared facilities				
	Automatic lock entrance, Elevator, Coin laundry			

Terms of contact with temporary visitor visa (3month)

LeaLea Midoribashi 23	LeaLea Midoribashi 25	LeaLea Midoribashi 26	LeaLea Midoribashi 30
No	No	No	No

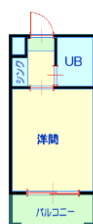
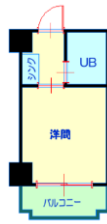

*The nearest station, commuting hours, transportation fee in this brochure is calculated from each school.
 *Information can be changed depending on the situation.
 *According to the local ordinance of Osaka City, oversized garbage disposal fee is required when disposing of Futons (Futon / blanket (up to 4 sheets) 200 yen). Please be careful when moving out.

Osaka YMCA International College				
	㊸ORI Daikokucho	㊸NA Kujo	㊸V Shinosaka	㊸R-SEKIME
	Male・Female			
Location				
Address	1-4-14 Ebisuohomachi, Naniwa-ku, Osaka	2-1-10 Kujo, Nishi-ku, Osaka	2-15-2 Higashinakajima	3-9-20 Sekime, Joto-ku, Osaka
Nearest station	Daikokucho Station	Kujo Station	nakajima Minamikata St	Sekime Station
Commuting time	About 20 minutes	About 20 minutes	About 30 minutes	About 31 minutes
	Walk → Subway → Walk	Walk → Subway → Walk	Walk → Subway → Walk	Walk → Train → Walk
Transportation fee	Commuter Pass(3months) ¥11,970	Commuter Pass(3months) ¥11,970	Commuter Pass(3months) ¥11,970	Commuter Pass(3months) ¥10,150
	Commuter Pass(6months) ¥22,680	Commuter Pass(6months) ¥18,530	Commuter Pass(6months) ¥22,680	Commuter Pass(6months) ¥19,230
(Bicycle)	About 30 minutes	About 15 minutes	About 30 minutes	About 30 minutes
Fee				
Deposit etc	①Deposit(Refundable): 0.5month rent fee + RLS ②Basic cleaning fee: ¥22,000 (when moving out) *RLS: Refer to the following "Others"			
Rent	¥58,000～73,000	¥55,000～58,000	¥41,000～43,000	¥41,000～45,000
	(Included: maintenance, water fee, Internet)			
Others	RLS: 2,000 yen / month (rent guarantee, fire insurance, 24-hour emergency response), electricity fee: actual cost, gas fee: actual cost			
Initial cost on move in date	Deposit: ¥50,000～ Entrance fee:20,000～ Previous rent: ①Daily payment rent of the current month + RLS and ②Rent for next month + RLS	Deposit: ¥57,000～ Entrance fee: 28,500～ Previous rent: ①Daily payment rent of the current month + RLS and ②Rent for next month + RLS	Deposit: ¥43,000～ Entrance fee:21,500～ Previous rent: ①Daily payment rent of the current month + RLS and ②Rent for next month + RLS	Deposit: ¥43,000～ Entrance fee:21,500～ Previous rent: ①Daily payment rent of the current month + RLS and ②Rent for next month + RLS
Room, facility				
Room	22～31㎡	18㎡	15～18㎡	15～20㎡
Bath room	Separate	Unit bath		
Mini kitchen	○			
Internet	Free WiFi is availavle at all rooms. Available from the day of move in. No additional fee nor penalty fee.			
Others	Elevator Entrance at the building - self lock Other(New):Futon ¥9,000, Ricecooker ¥7,000, Name stamp set ¥2,000 (Stamp + Stamp Case)			
Shared facilities				
	Elevator, bicycle parking lot	Air conditioner, refrigerator, microwave, Vacuum cleaner, washing machine, bed, chair, desk, closet hangers, curtain, lightning	Air conditioner, refrigerator, microwave, Vacuum cleaner, washing machine, bed, chair, desk, closet hangers, curtain, lightning, sharing coin laundry	Automatic door lock, stairs, Bicycle parking lot (limited on the number of vehicles)

Terms of contact with temporary visitor visa (3month)

ORI Daikokucho	NA Kujo	V Shinosaka	R-SEKIME
Deposit: 20,000 yen (refund when moving out) 3 months usage fee: 225,000 yen * *Includes futon, electricity, gas, water, internet, fire insurance, and basic cleaning			

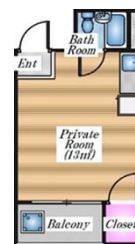

*The nearest station, commuting hours, transportation fee in this brochure is calculated from each school.
 *Information can be changed depending on the situation.
 *According to the local ordinance of Osaka City, oversized garbage disposal fee is required when disposing of Futons (Futon / blanket (up to 4 sheets) 200 yen). Please be careful when moving out.

Common	Osaka YMCA Gakuin /Osaka YMCA International college			
	㊦Chateau Hanazono 3 ㊦Chateau Hanazono 4		㊦Chateau Hanazono7	
	Male・Female		Male・Female／(1people)	Male・Female／(2person)
Location				
Address	2-5-3, Hanazono kita, Nishi-ku, Osaka-city		1-6-21, Tsurumibashi, Nishi-ku, Osaka-city	
Nearest station	Subway Yotsubashi line [Hanazonocho]			
Commuting time	To Osaka YMCA Gakuin:About 20minutes Walk → Subway Yotsubashi iine → Subway Midosuji line → Walk To Osaka YMCA International college:About 22minutes Walk → Subway Yotsubashi iine → Walk			
Transportation fee	commuting ticket (3months) :25,940yen commuting ticket for students (3months) :11,970yen			
(Bicycle)	To Osaka YMCA Gakuin:About 17 minutes/ To Osaka YMCA International college: Not be able to go to school by bicycle			
Fee			Per 1person	
Deposit etc	Deposit ¥0 At the time of moving in :house cleaning fee ¥25,000		Deposit ¥15,000(Non refundable) At the time of moving in :house cleaning fee ¥12,500	
Rent	¥31,000～38,000yen／month <small>(Included:maintenance and water fee)</small>	¥33,000～38,000yen／month <small>(Included:maintenance and water fee)</small>	①¥32,000～37,000yen／month <small>(Included:maintenance and water fee)</small> ②¥44,000～45,000/month <small>(Included:maintenance and water fee)</small>	¥28,000～30,000yen／month <small>(Included:maintenance and water fee)</small>
Others	Electricity fee: Actual expenses Gas fee:Actual expenses Fire insurance fee ¥500／month			Electricity fee: Actual expenses Gas fee:Actual expenses Fire insurance fee ¥250／month
Initial cost on move in date	Deposit ¥0 Rent at the current month(daily basis) +rent for next month Fire insurance fee ¥500 (Not daily basis) House cleaning fee ¥25,000			Deposit ¥15,000 Rent at the current month (daily basis) + rent for next month Fire insurance fee ¥250 (Not daily basis) house cleaning fee ¥12,500
Room, facility				
Room	11.52～12.50㎡	13.36～14.79㎡	①1R 12.47～14.21㎡②1K 18.60～19.90㎡	2K 31.82～37.41㎡
Bath room	Unit bath			
Mini kitchen	○			
Internet	Free Wi-Fi is available at all rooms (Available from the day of move in, No additional fee nor penalty fee) ※ Cable is available			
Others	Air conditoner, regrigerator, washing machine, lightning, IH cooking heater, desk, char, bed, wardrobe (futon:proxy purchase before moving in is availalbe…7,000yen) (Additional option of furniture-microwave, rice kooker:10,000yen) Registration fee for bicycle parking area:1000yen(only first time)			Air conditioner×2, refrigerator, washing machine, lightning, IH cooking heater, bed×2, desk×2, chair×2, wardrobe×2 (futon: proxy purchase before moving in is availalbe…8,000yen) (Additional option of furniture-microwave, rice kooker: 10,000yen)
Shared facilities				
	Elevator / Bicycle parking area 1,000yen(first time only)/ Janitor assigned			

Terms of contract with temporary visitor visa

Chateau Hanazono 3	Chateau Hanazono 4	Chateau Hanazono7
¥159,500 / 3months Electricity, gas, water, internet fee are included.(Only darker rooms)		No

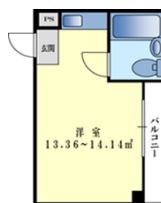
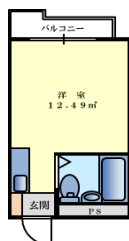

Rental furniture
 Long term contract 2sets \10,000
 Short term contract:free