

Application Guide

Osaka YMCA was founded in 1882, with the aim of fulfilling the Biblical phrase, "Bring all the people as one," by transcending nationality, ethnicity, religion and belief. Osaka YMCA Japanese Language School was established in 1969 with the vision of the development of mutual understanding between people from different cultural backgrounds. Over 50 years, it has enabled people to develop a high level of language proficiency and to truly play an active role as a global citizen. We support each individual student to fulfill his or her purpose of life. We instruct students whole heartedly with the desire that they will grow to be a dedicated member of a harmonious society.

■ Comprehensive Japanese Language Course

- A curriculum with consideration for from countries do not use Chinese characters
- Persons who completed 10- or 11-year elementary and secondary educations

Please refer to page 3 for further details.

Comprehensive Japanese and University Entrance Course

This course is for those who aim to go to university in Japan. The easy-to-learn curriculum for learners from countries that do not use Chinese characters, in particular, will develop academic skills as well as advanced Japanese-language skills through their reasonable learning. Students will study in Japanese and learn about Modern Japanese Society, Geography, History, English, Science and Mathematics in order to pass the EJU (The Examination for Japanese University Admission for International Students / Nihon-Ryugaku Shiken). In addition, the school provides fine-grained course consultation services and career guidance according to the goal of each student through homeroom activities once a week along with proper counseling.

Approved by the Japanese Ministry of Education, Culture, Sports, Science and Technology



In order to fulfill requirements for going to universities in Japan, students must have successfully completed 12 or more years of formal education in their native countries. In the case of countries and regions where formal education until completion of high school is less than 12 years, applicants are disqualified from applying to universities in Japan. Applicants will be eligible to apply for universities in Japan after completing a University Preparatory Course approved by the Japanese Ministry of Education, Culture, Sports, Science and Technology and becoming 18 years old. The Comprehensive Japanese Language Course at the Osaka YMCA has been approved as a University Preparatory Course by the Japanese Ministry of Education, Culture, Sports, Science and Technology.

■ Practical Japanese Language Course

Please refer to page 5 for further details.

Japanese language that is practical for daily life and business

This course offers Japanese classes which are useful for daily life and business. The beginner and intermediate courses provide basic Japanese classes. The four technical skills are divided into two related groupings, listening-speaking and reading-writing, so that the students are able to improve their Japanese abilities intensively and effectively. In the advanced course, half of the classes are electives. Students can select five electives which match their own study purpose from within the following themes, Business, Culture and Academic. In addition, Job seeker from Intermediate class and above can get professional consultant. On the other hands, receive guiden to compose the CV, Entry sheet, also how to get a interview or how to begin the job hunting.

I . Application Procedure(In the Case of a Student Visa)

1 Apply to the YMCA

(1) Domestic Application

Please make an appointment before submitting your application form or taking an interview. We may refuse to accept an application form or an interview if you do not have an appointment.

Prepare all the necessary documents (please refer to the Application Instructions). They must be submitted by a representative on your behalf to the reception desk of the Osaka YMCA Japanese Language School.

(2) Overseas Application

Applicants applying through the Osaka YMCA subcontracted agencies need to follow the application procedure of the agency.

<<Overseas Subcontracted Agencies>>

- Hong Kong : Dai-ichi Japanese Language and Culture School, Hong Kong Overseas Studies Centre, HELLO Japan, SHIN Japanese
- Macau : Learning Center, TAMAGO language research center, Takadababa Japanese language school, Golabo Education center, etc.
- Vietnam : REDBOOK, Esuhai., GotoJapan, etc.
- Malaysia : EDU DOTCOM, Q-Wei Consulting Services, etc.
- Indonesia : Japan Indonesia Network (Bandung)、Orion Harmoni Mandala (Bandung)、未来企画 (Medan)、NEXS Japanese Language Center (Surabaya)
- Thailand : JEDUCATION (Bangkok)、ICHIBAN Japanese Language Center (Chiang Mai)
- Russia : MANABO

1. Eligibility for Application

Those who fulfill conditions ① and ②.

- ① High school graduates or those who have been approved by the Japanese Ministry of Education, Culture, Sports, Science and Technology as having acquired equivalent or higher academic ability than those previously mentioned.

Comprehensive Japanese Language Course :

Applicants from countries where the period of formal education up to the high school level is less than 12 years are also eligible to apply. In that case, applicants must be eligible to apply for university in their home country.

- ② Those who have passed the N5 level (previously 4) of the Japanese Language Proficiency Test or Class F of the J-TEST or those who have completed 150 hours of Japanese study at school or at a language institute.

※ If you have any relatives or acquaintances living in Japan, we will register them as contacts.

2. Application Period

	COMPREHENSIVE JAPANESE LANGUAGE COURSE (A University Preparatory Course)		PRACTICAL JAPANESE LANGUAGE COURSE	
	Chinese • Bangladeshi Vietnamese • Mongolian Nepalese • Burmese	Other nationalities not listed to the left	Chinese • Bangladeshi Vietnamese • Mongolian Nepalese • Burmese	Other nationalities not listed to the left
Enrollment in April	Early Sept. – Mid-Nov.	Early Sept. – Early Dec.	Early Sept. – Mid-Nov.	Early Sept. – Early Dec.
Enrollment in July	-	-	Early Jan. – Mid-Mar.	Early Jan. – Late Mar.
Enrollment in October	Early Mar. – Mid-May	Early Mar. – Early June	Early Mar. – Mid-May	Early Mar. – Early June
Enrollment in January	-	-	Early June – Mid-Sept.	Early June – Late Sept.

※ Those who have obtained a visa other than a student visa can apply up until the end of the month preceding the start of the semester.
 ※ The application period will be closed when the maximum number of students has been accepted.

3. Application Documents

Please refer to the Application instructions.

! Course Selection

The Osaka YMCA Japanese Language School provides two courses for the needs of our students. You will not be allowed to change courses after submitting the application form. Please be fully aware of the features of each course before applying.

In-School Screening / Selection

- Applicants will be accepted based on the results of the screening of application documents and other reviews.
- Results will be sent by mail after the in-school screening.

Enrollment	April	July	October	January
In-school screening Result				
Period of application to the immigration office	Mid-Dec.	Late Mar.	Mid-June.	Late Sep.
Result from the immigration office	Next Early Mar.	Early June.	Early Sep.	Early Dec.

Applying at the Immigration Office

- The Osaka YMCA Japanese Language School Administration Office will apply for a Certificate of Eligibility at the Immigration Office for all those who are accepted.
- It usually takes three months for the Immigration Office to process the application documents.

Announcement of visa application result, issuing a Certificate of Eligibility

- When the Immigration Office approves the application, the Certificate of Eligibility will be sent directly to the school.
- The administration office will send a tuition invoice to successful applicants.
- The administration office will send the Certificate of Eligibility, after confirming the payment of tuition.

2 Obtaining a Visa

- Applicants need to apply for a visa at the Japanese Embassy or Consulate in their home country. You need to bring your Certificate of Eligibility, the letter of acceptance and your passport.
- The time taken for processing an application to issue a visa varies between diplomatic establishments in each country.
- The Certificate of Eligibility is valid for three months after the date of issue.
- For applicants who want to live in accommodations recommended by the Osaka YMCA, they can apply before entrance.

3 Arrival in Japan / Entrance ceremony / Orientation

- An orientation seminar and a level test will be conducted before the course begins.
- We will conduct orientation seminars relating to the opening of a bank account, buying a cell phone, and part time work.

4 Class Begins

II . Comprehensive Japanese Language Course

(University Preparatory Course)

Enrollment	Maximum Number of Students	Class Schedule								
April (1-year course, 2-year course) October (1.5-year course)	160 Maximum 18 students per class	Monday to Friday 9:00 a.m. – 2:40 p.m. <u>5 classes per day</u>								
Suitable for	People who aim to go to universities in Japan									
Course Length and Levels	1-year course, 1.5-year course, 2-year course Beginner, Pre-intermediate, Intermediate, Upper-Intermediate, Advanced, Upper Advanced									
	FIRST YEAR	SECOND YEAR								
Enrollment in April	2 years course	<table border="1" style="width: 100%;"> <tr> <td style="text-align: center;">Beginner</td> <td style="text-align: center;">Pre-Intermediate</td> <td style="text-align: center;">Intermediate</td> <td style="text-align: center;">Upper Intermediate</td> </tr> <tr> <td style="text-align: center;">Intermediate</td> <td style="text-align: center;">Upper Intermediate</td> <td style="text-align: center;">Advanced</td> <td style="text-align: center;">Upper Advanced</td> </tr> </table>	Beginner	Pre-Intermediate	Intermediate	Upper Intermediate	Intermediate	Upper Intermediate	Advanced	Upper Advanced
	Beginner	Pre-Intermediate	Intermediate	Upper Intermediate						
Intermediate	Upper Intermediate	Advanced	Upper Advanced							
1 year course	<table border="1" style="width: 100%;"> <tr> <td style="text-align: center;">Intermediate</td> <td style="text-align: center;">Upper Intermediate</td> </tr> </table>	Intermediate	Upper Intermediate							
Intermediate	Upper Intermediate									
Enrollment in October	1.5 year course	<table border="1" style="width: 100%;"> <tr> <td style="text-align: center;">Beginner</td> <td style="text-align: center;">Pre-Intermediate</td> <td style="text-align: center;">Intermediate</td> </tr> <tr> <td style="text-align: center;">Intermediate</td> <td style="text-align: center;">Upper Intermediate</td> <td style="text-align: center;">Advanced</td> </tr> </table>	Beginner	Pre-Intermediate	Intermediate	Intermediate	Upper Intermediate	Advanced		
	Beginner	Pre-Intermediate	Intermediate							
Intermediate	Upper Intermediate	Advanced								

★Please choose from the above courses.
If you start from the Beginner level, you need to complete either the 1.5-year course or 2-year course in order to apply to universities in Japan.

★If you would like to study for a period less than one year (about six months), please consult with the office staff.

● Curriculum (920 hours per year)

1. Comprehensive Japanese Language Course Subjects (21 hours per week)

- ★ Improve all your Japanese language skills through high quality and systematic teaching.
- ★ Students can also intensively prepare for the EJU (The Examination for Japanese University Admission for International Students / Nihon-Ryugaku Shiken) and for the JLPT.

Components	Contents	
Comprehensive Japanese Class	The school has a unique curriculum and teaching method with consideration for people from countries that do not use Chinese characters to enable them to learn four integral skills, i.e., listening, speaking, reading, and writing Japanese.	
Preparation for the EJU (The examination for Japanese University Admission for International Students) & Preparation for the JLPT (Japanese Language Proficiency Test)	Preparation for the EJU	Preparation for the JLPT
	Beginner	No classes
	Intermediate	50 minutes × 2 hours/week
	Advanced	50 minutes × 4 hours/week
		50 minutes × 2 hours/week (Only 8 weeks in May & Jun. or Oct. & Nov.)
		50 minutes × 2 hours/week
		50 minutes × 4 hours/week

2. Basic Examination Subjects (4 hours per week)

★ We thoroughly teach the basic subjects necessary for university entrance examinations.

Components	Contents
Modern Japanese Society, Geography, History	<ul style="list-style-type: none"> • Students learn about Modern Japanese Society, Politics and Economics, Geography, and History. The classes are taught in Japanese. • Students can develop their academic skills, such as researching and writing papers. • This is intended for general subjects of the EJU (The examination for Japanese University Admission for International Students / Nihon-Ryugaku Shiken) required for university entrance.
Higher Education Entrance Preparation	<ul style="list-style-type: none"> • Students learn about time management, life and culture, such as cross-cultural adaptation, independent study, such as learning management, learning skills, collecting information and preparation for their higher education entrance examinations.
English	<ul style="list-style-type: none"> • Students will be divided into different levels based on their English proficiency and learn English from the Japanese point of view. • Excellent preparation for the TOEFL test used for university entrance examinations. • A Japanese to English translation class is offered to students with advanced English.

☆ Students will acquire a high level of Japanese proficiency and essential knowledge. Studying these subjects in Japanese will be helpful for studying at university and as preparation for the working environment in Japan.

☆ For university candidates, it is good preparation for the EJU (The examination for Japanese University Admission for International Students / Nihon-Ryugaku Shiken) that many universities use as a part of their selection examination.

In addition to the above subjects, we offer other classes, such as mathematics and science. (Additional fees apply)

[Ref] Test subjects for the EJU (The examination for Japanese University Admission for International Students / Nihon-Ryugaku Shiken)

- Humanities Course - Japanese, Mathematics, General subjects (Geography, History, Modern Japanese Society)
- Science Course - Japanese, Mathematics, Sciences (Choose 2 subjects from Physics, Chemistry, and Biology).

Sample Timetable (There may be changes each year)

Monday - Friday, 9:00 a.m. to 2:40 p.m., 5 classes, 50 minutes per class.
Maximum 18 students per class. All classes consist of a small group of students.

		Monday	Tuesday	Wednesday	Thursday	Friday
1	9:00-9:50	English	Higher Education Entrance Preparation	Japanese	Japanese	Japanese
2	10:00-10:50	Japanese	Japanese	Japanese	Japanese	Japanese
3	11:00-11:50	Japanese	Japanese	Japanese	Japanese	Japanese
	11:50-12:50	Lunch break				
4	12:50-13:40	Preparation for the EJU	Japanese	Preparation for the JLPT	Japanese	History/Physics
5	13:50-14:40	Preparation for the EJU	Japanese	Preparation for the JLPT	Japanese	Geography/Biology

Financial support is available for the Comprehensive Japanese Language Course

- Scholarships
After having completed 6 months of study or more, students who excel at class work can apply for the Osaka YMCA International Scholarship or JASSO Scholarship.
- Student Commuter Pass
Students planning to study more than one year at the Osaka YMCA are eligible to apply for a student discount for a commuter pass.

III. Practical Japanese Language Course

<p>Enrollment</p>	<p>Maximum Number of Students</p>	<p>Class Schedule</p>
<p>4 times per year April, July, October, and January (The longest course is 2 years)</p>	<p>340</p>	<p>Morning Classes Monday to Friday 9:00 ~ 12:50 <u>4 classes per day</u> Afternoon Classes Monday to Friday 13:30 ~ 17:20 <u>4 classes per day</u></p>
<p>Suitable students for this course</p>	<p>Students who need language training or who hope to go to technical colleges in Japan or who need to use Japanese at work or in their daily lives.</p>	
<p>Course Period and level</p>	<p>Level from 6 months to a maximum of 2 years depending on their situations. 3-month courses are also possible. 10 Levels - Introductory Japanese, Basic 1/2, Pre-Intermediate, Intermediate 1/2/3, Advanced 1/2, Upper Advanced</p> <ul style="list-style-type: none"> ※ Not all levels are available every semester. ※ We don't offer replacement classes. Students must take their regularly scheduled morning or afternoon class. ※ Inform the school of your desired time zone of learning at the time of your application. Keep in mind that your request may not be always accepted, because the school will determine the time zone in the order of each student's application and according to the results of a placement test. 	

● Curriculum (800 hours a year) ... 200 hours per semester × 4 semesters

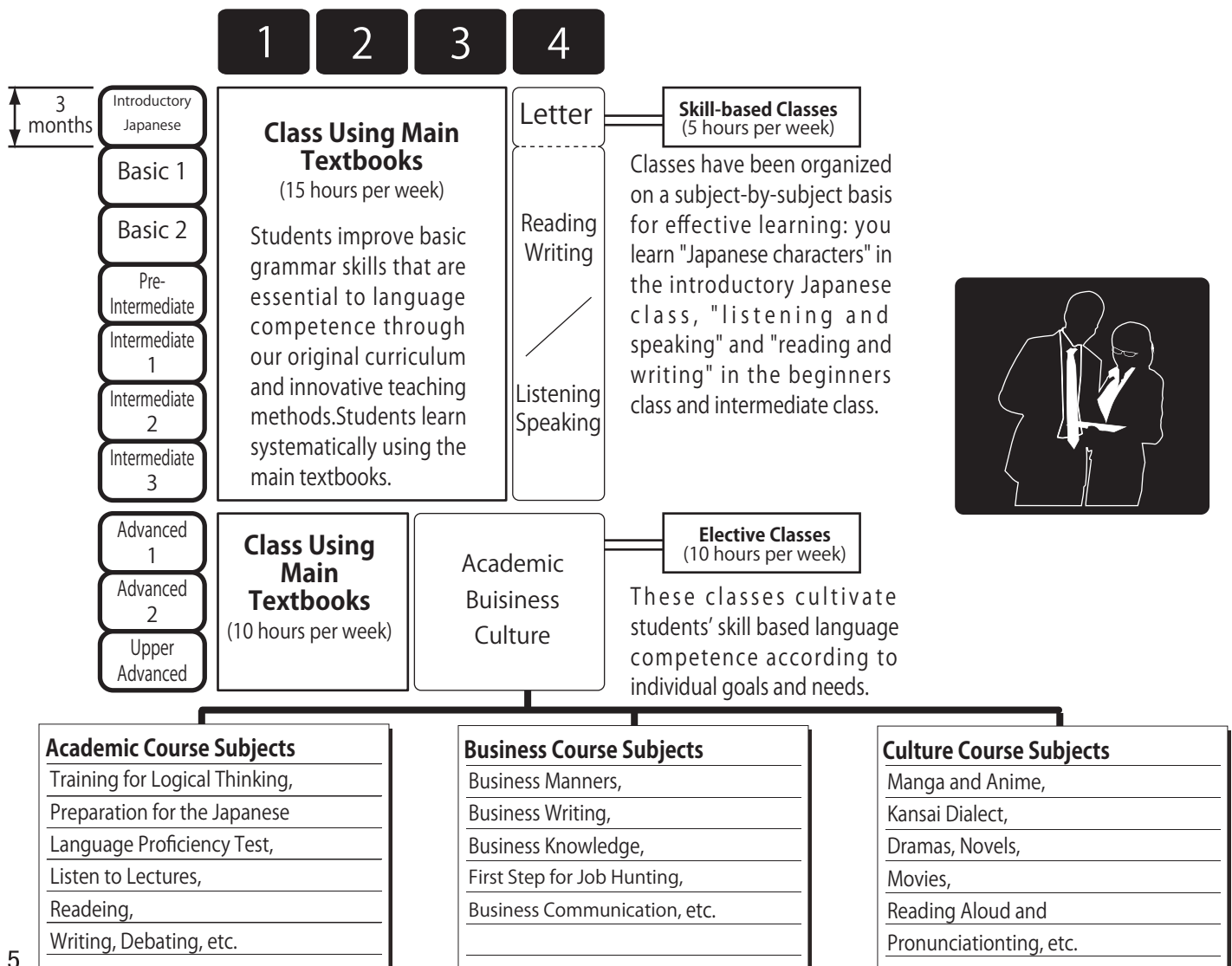

Sample Timetable (There may be changes each year).

Monday to Friday, 4 classes, 50 minutes per class

1. Basic - Intermediate

	Morning Classes	Afternoon Classes	Mon	Tue	Wed	Thur	Fri
1	9:00-9:50	13:30-14:20	Japanese	Japanese	Japanese	Japanese	Japanese
2	10:00-10:50	14:30-15:20					
3	11:00-11:50	15:30-16:20					
4	12:00-12:50	16:30-17:20					
			Listening-Speaking	Reading-Writing	Listening-Speaking	Reading-Writing	Listening-Speaking

2. Advanced

	Morning Classes	Afternoon Classes	Mon	Tue	Wed	Thur	Fri
1	9:00-9:50	13:30-14:20	Japanese	Japanese	Japanese	Japanese	Japanese
2	10:00-10:50	14:30-15:20					
3	11:00-11:50	15:30-16:20					
4	12:00-12:50	16:30-17:20					
			Business Manners	Preparation for the JLPT N1.	Dramas	Writing	Kansai Dialect

	Contents
A Academic Course Subjects	• We aim at acquiring more advanced four skills(reading, writing, listening, speaking) , which is also useful for academic achievement such as preparation for Japanese Language Proficiency Test.
B Business Course Elective Subjects	• Students learn basic business knowledge and skills which will be useful when they work in Japan in the future.
C Culture Course Elective Subjects	• Deepen your knowledge of Japan through various topics to understand the differences between Japan and your country which you are aware of in your life in Japan.

Financial support is available for the Practical Japanese Language Course

● Scholarships

After having completed 6 of months study or more, students who excel at class work can apply for the Osaka YMCA International Scholarship or JASSO scholarship.



The public transportation student discount commuter pass does not apply to students in the Practical Japanese Language Course due to public transportation regulations.

IV. Tuition

1. Tuition Total

Breakdown

(Japanese Yen)

Course	The length of courses	Total	Application Fee	Entrance Fee	Tuition	Student 24 hours Mutual Insurance	Printing fee		
Comprehensive Japanese Language Course	24 months	1,630,000	20,000	100,000	1,480,000	14,000	16,000		
	18 months	1,252,600			1,110,000	10,600	12,000		
	12 months	875,000			740,000	7,000	8,000		
	6 months	497,600			370,000	3,600	4,000		
Practical Japanese Language Course	24 months	1,550,000			-	50,000	1,400,000	14,000	16,000
	21 months	1,371,400					1,225,000	12,400	14,000
	18 months	1,192,600					1,050,000	10,600	12,000
	15 months	1,013,800					875,000	8,800	10,000
	12 months	835,000					700,000	7,000	8,000
	9 months	656,400					525,000	5,400	6,000
	6 months	477,600					350,000	3,600	4,000
	3 months	228,800					-	50,000	175,000

Notice ① An extra fee will be applied to students that register for an extracurricular subject or a supplementary class.

② The cost of textbooks is collected on the actual cost after your class placement. (About ¥ 5,000)

③ Please refer to the support section on page 8 about the details of the Student Life Support System.

2. Payment Methods

Please use Flywire to transfer the tuition fees.

You can pay with local currency or credit card from Flywire website.



※Note :

- Please check the Flywire website for input method. The address of the website will be written on the tuition invoice.
- Depend on overseas agency, you may have to pay in advance. Please confirm for more informations.

3. Refund

* The application fee is a handling fee for the Osaka YMCA and is used to make a decision whether or not to accept an applicant. (It is not the fee to apply for your visa.) The examination fees are not refundable.

* Tuition is not refundable except in the following cases.

① Before Starting Your Course

- When the visa application is rejected even though the proper application procedures were followed, the full amount including entrance, tuition and materials will be refunded.
- When cancellation of acceptance is for personal reasons, the full amount, excluding the entrance fee, will be refunded.

② After Starting Your Course

- If a student is accepted by a university in Japan before completion of the Japanese language course and the university's term parallels with that of the Osaka YMCA's, the tuition equivalent to the remainder of the term will be refunded. All handling charges will be deducted from refunds.

V. Other Features / Benefits

Volunteer and Mutual Exchange

★ Volunteer Tutor System

Weekly tutorials by Japanese volunteers offer enjoyable conversation practice and opportunities to interact with people.

Students can freely talk about Japanese people, Japanese culture and their own country. They will be able to brush up their speaking skills in a friendly atmosphere.

★ There are plenty of opportunities to interact with Japanese people.

By participating in volunteer programs organized by the Osaka YMCA and having close contact with people in elementary schools, junior high schools and high schools in the local community, students will have more opportunities to meet Japanese people and be able to expand their network.

Support System

★ Student 24 hours Mutual Insurance

All students can join the system at the Osaka YMCA. This system covers accidents and damage that take place in school life and daily life. It also prepares for situations such as environmental changes at home, whereby students are unable to continue to go to school.

※It is applied to medical expenses in case of incidental injury, liability compensation for accidents caused by students in daily life, and death of students or their sponsors due to injury or illness. Support is available 24-hours a day both in Japan and overseas.

※In the case of illness or injury, you will need to pay your own medical expenses. For this reason, those staying in Japan more than 1 year need to join Japanese National Health Insurance Program. Those who come to Japan and enter school with a temporary visitor visa, please obtain travel insurance in your country.

★ To Christian Clergymen and NGO and NPO Workers

The Osaka YMCA provides a special discount and scholarships for school tuition to those who are Christian clergymen, NGO or NPO workers who are required to acquire Japanese language.

★ Reduction and exemption system

We have reduction and exemption system for those who have already passed below test score.

① JLPT N2 or N1

② EJU (Examination for Japanese University Admission for International Students): Students with above 220 score, excluding the score of Writing test. ※Only for those who apply for Comprehensive Japanese Language Course.

③ J.TEST (Test of Practical Japanese) A-C level test: Above 600 score.

④ The Japanese Language NAT-TEST: Above Level 2.

⑤ J-Cert (Certificate of Japanese as a Foreign Language): A-course Pre-Advance or Advance Level.

⑥ JPT (Japanese Proficiency Test): Above 525 score.

⑦ TOP-J: Above Intermediate B.

If you want to apply for the Reduction and exemption system, please tell us when you submit your Application form.

You need to submit a written oath and a certificate showing above test score.

University & Technical College Information

The Osaka YMCA can recommend admission to the following universities.

- | | |
|---|---|
| <ul style="list-style-type: none">• Kwansei Gakuin University (School of Policy Studies)• Taisei Gakuin University (Faculty of Human Studies, Faculty of Management)• Osaka University of Tourism (Faculty of Tourism & Culture)• Osaka Seikei University (Faculty of Art & Design, Faculty of Management) | <ul style="list-style-type: none">• Kobe Gakuin University• St. Andrew's University• Ryutu Keizai University• Otomon Gakuin University (Faculty of Economics, Faculty of Management) |
|---|---|

We can also recommend students for admission with privileges, such as waving of examination fees, to the following technical colleges.

- | | |
|--|---|
| <ul style="list-style-type: none">• Osaka YMCA International College (International Hotel Studies, International Business)• Hiko Mizuno College of Jewelry• Syusei Technical College• HAL Osaka• ECC College of Foreign Language | <ul style="list-style-type: none">• ECC Computer College• ECC Artist Beauty College• Osaka Comprehensive Design College |
|--|---|

※It changes every year, please contact for more informations.

VI. Accommodation

YMCA recommended student accommodations will be introduced upon request.

Please look at the Osaka YMCA Gakuin Web site for more details about student accommodations.
<https://www.osakaymca.ac.jp/nihongo/>

R-Momodani

R 桃谷マンション

Near from school and furnished with Free Wi-Fi.

Address	3-8-23 Katsuyamakita, Ikuno-ku, Osaka-shi, Osaka	
Commuting Time	Approximately 15 minutes (one way)	
Room Facilities	16 m ² , Unit bath, Small kitchen, AC, Refrigerator, Microwave, Washing Machine, Vacuum cleaner, Curtain, etc.	
Shared Facilities	Elevator, Auto lock, Bicycle parking space	
Fees	Deposit	1 month rent fee (Refundable at the time of moving out)
	Rent	¥45,000 ~ 49,000 (Include : Maintenance Fee, Water Bill, Fire Insurance)
	Others	Electricity fee : Actual expenses / Gas fee : Actual expenses

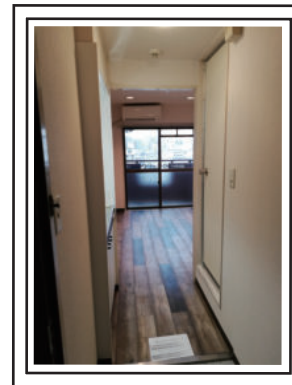
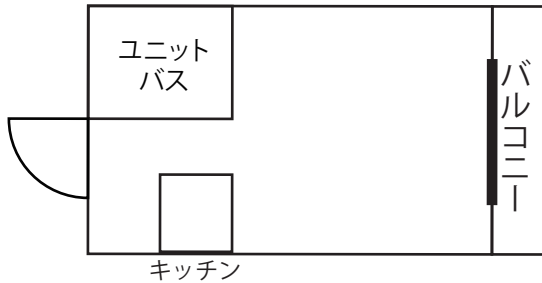

Chateau-IMAZATO シャトー今里

The room features a balcony and the Internet access.

	① 1. Chateau Imazato I	② 1. Chateau Imazato II
Address	3-2-16, Shin Imazato, Ikuno-ku, Osaka-City	3-2-7, Shin Imazato, Ikuno-ku, Osaka-City
Commuting Time	Approximately 25 minutes (one way)	
Room Facilities	12 - 14 m ² , Unit bathroom, Mini-kitchen, Air conditioner, Refrigerator, Washing machine	
Shared Facilities	No Elevator	Elevator
Fees	Deposit	No
	Rent	¥ 29,000 ~ 40,000 (Including building maintenance fee or water and internet fee)
	Others	Electric rate : Actual expense Gas rate: Actual expense Fire insurance : 500 yen /month

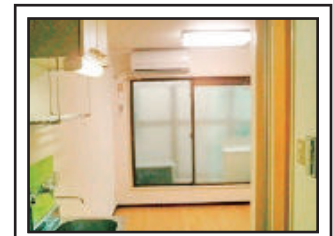
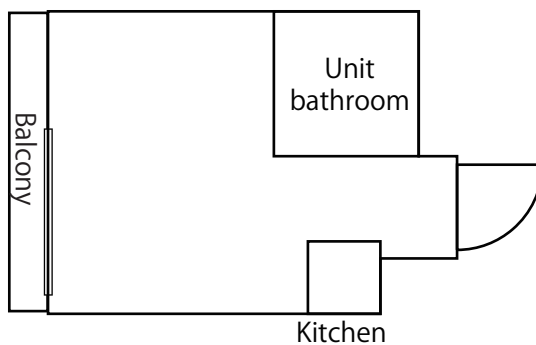

TOYAMA-SO
とやま(外山)荘

We assure you that you will feel secure having the landlord who is a long time member of YMCA.

Address		8-2-15, Sunji-yata, Higashi Sumiyoshi-ku, Osaka-City
Commuting Time		Approximately 40 minutes (one way)
Room Facilities		6 - 8 tatami mats (approximately 10 - 13 m ²), Toilet, Mini-kitchen, Air conditioner, Refrigerator, Bed, Futon, Electric cooking stove, Desk, Chair
Shared Facilities		Washing machine, Dryer, Iron, Vacuum cleaner, Microwave, Toaster oven, Shower room, Lounge with TV
Fees	Deposit	No
	Rent	¥ 28,000 Included: maintenance and water fee, internet charge
	Others	Electricity charge is included into the rent (Maximum less than 50kW per a month). If you use more, you have to defray the actual expenses.

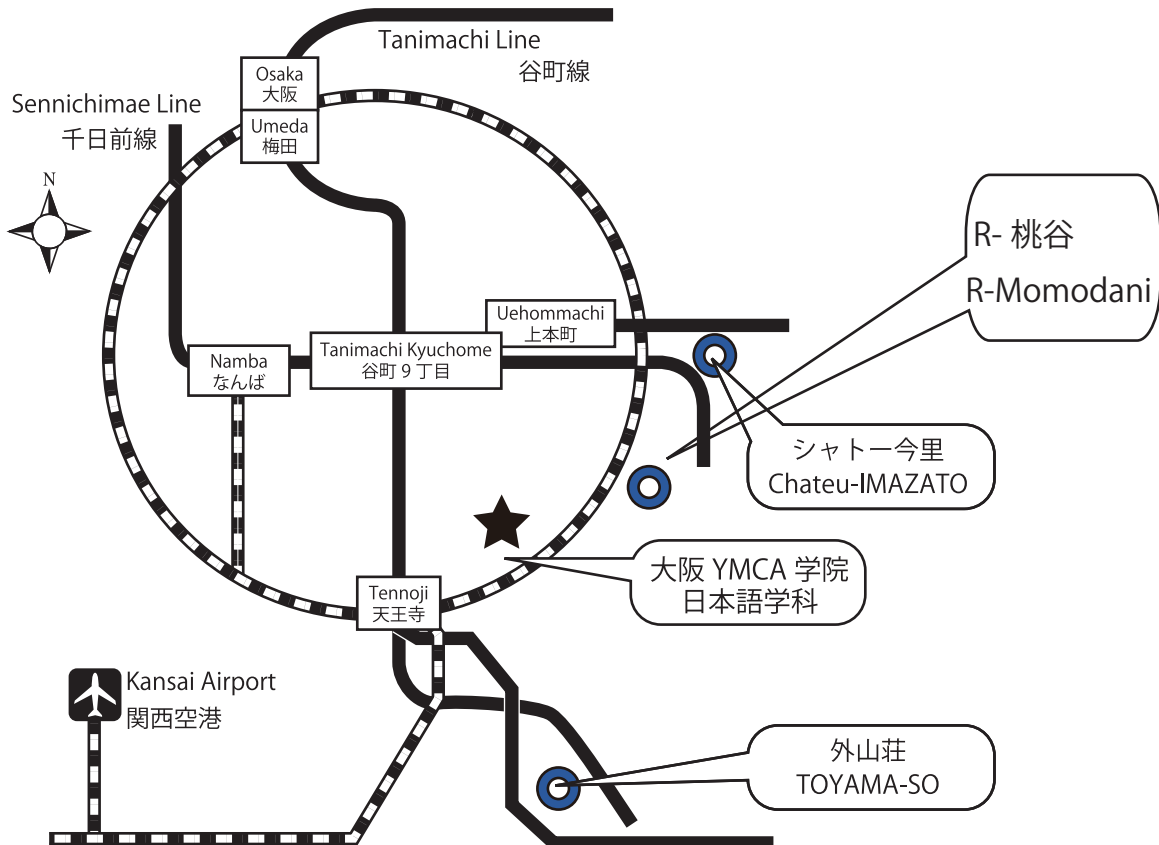
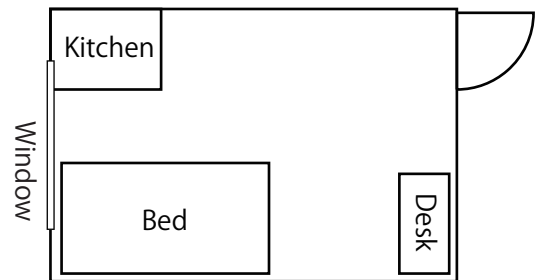
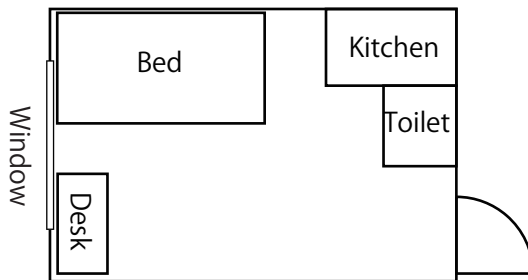



Access to Osaka YMCA Gakuin

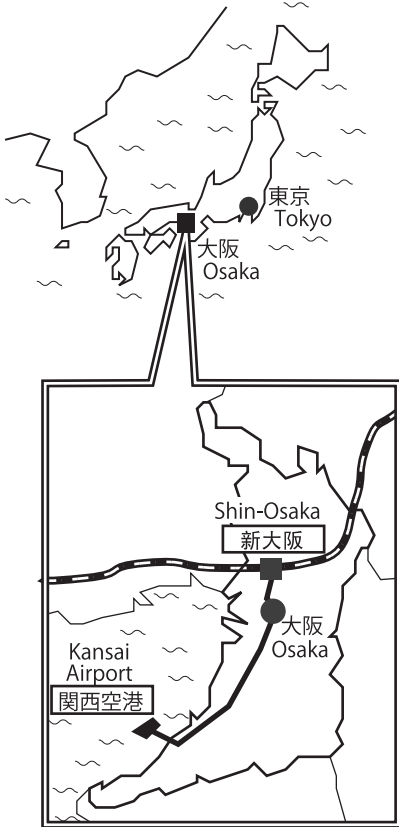

From Kansai International airport by JR

関西空港
Kansai Airport

JR

45mins

天王寺駅
Tennoji station

On foot

5mins

大阪 YMCA 学院
日本語学科

From Kansai International airport by a bus

関西空港
Kansai Airport

Airport Limousine

55mins

あべのハルカス
(天王寺駅)
Abeno Harukas
(Tennoji station)

On foot

10mins

Osaka YMCA Gakuin
Japanese Language School

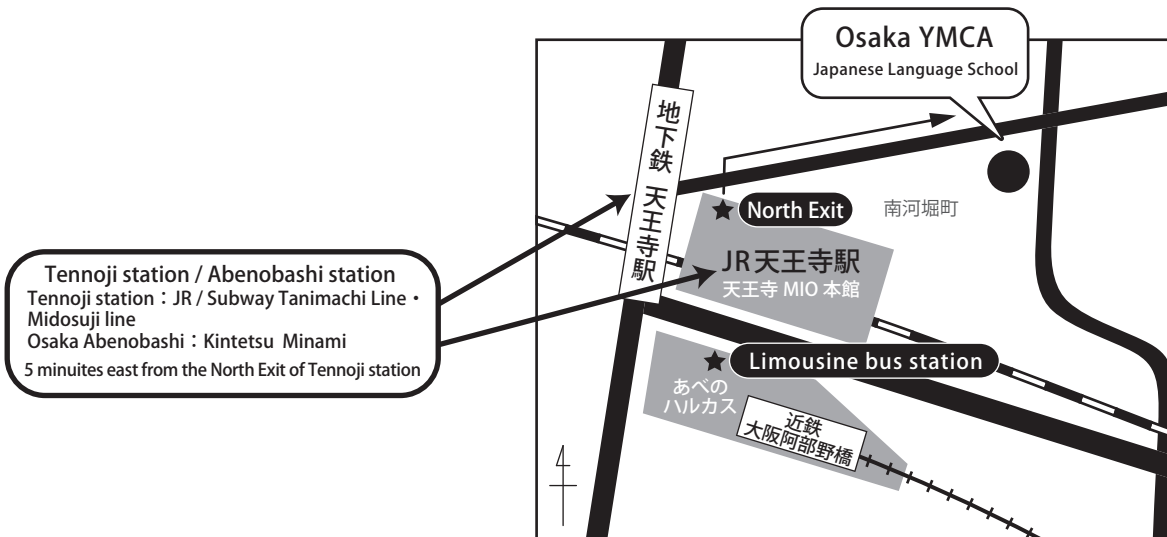

Osaka YMCA Japanese Language School (Tennoji branch)
<https://www.osakaymca.ac.jp/nihongo/>

9-52 Minawami kawahori-cho, Tennoji-ku, Osaka-shi, Osaka 543-0054

TEL : 06-6779-8364 FAX : 06-6779-1833

E-mail : info-jp@osakaymca.org

Business Hours: Monday to Friday (Closed on Saturdays, Sundays and National Holidays)

○ For Applying : 9:00 a.m. – 6:00 p.m.

○ General Inquiries : 9:00 a.m. – 7:00 p.m.